

PTW Series Inductive Proximity Sensors



M30 (30 mm) stainless steel - DC

- 4 models available/Low cost/high performance
- M12 quick-disconnect models rated IP67, axial cable models rated IP68
- LED status indicators are visible at a wide angle
- Sense all metals at the same distance
- One-piece stainless design

PTW Series M30 DC SS Inductive Prox Selection Chart							
Part Number		Sensing Range	Housing	Output State	Logic	Connection	Dimensions
PTW-AN-5A	<--->	20mm (0.787in)	Shielded	N.O.	NPN	2m (6.5') axial cable	Figure 1
PTW-AP-5A	<--->				PNP	2m (6.5') axial cable	Figure 1
PTW-AN-5H	<--->				NPN	M12 (12mm) connector	Figure 2
PTW-AP-5H	<--->				PNP	M12 (12mm) connector	Figure 2

Specifications	
Type	Shielded
Operating Distance	20mm (0.787in)
Material Correction Factors	*See Material Influence table #3
Differential Travel	≤15%
Repeat Accuracy	≤5%
Operating Voltage	10-30VDC
Ripple	≤20%
Load Current	≤200mA
Voltage Drop	≤2.0V
Output Type	NPN or PNP, N.O. only
Leakage Current	≤100µA
Switching Frequency	100Hz
(tv) Time Delay Before Availability	≤10ms
Temperature Range / Temperature Drift	-25° to +70° C (-13° to 158° F) / 10%Sr
Protection Degree (DIN 40050)	IEC IP67 ¹ (connector) IP68 ¹ (cable)
LED Indicators	Yellow (N.O. output energized) ⁷
Housing Material	Stainless steel
Sensing Face Material	Stainless steel
Tightening Torque	150Nm (111lb./in.)
Weight	114g (4.02oz)/50g (1.76oz)

¹ Fully submersible to 290 psi (20 bar).

*See Material Influence table #3 on page 17-53

Wiring diagrams

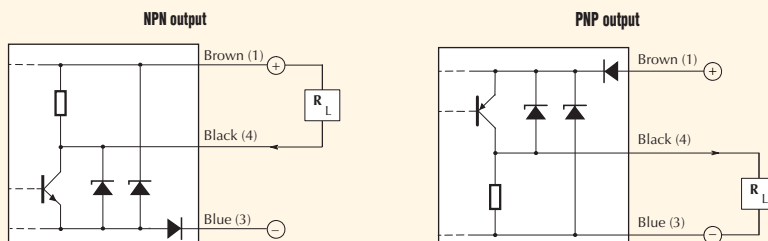

Dimensions

Figure 1

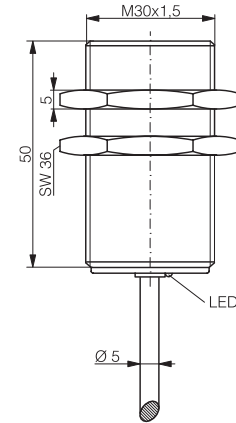
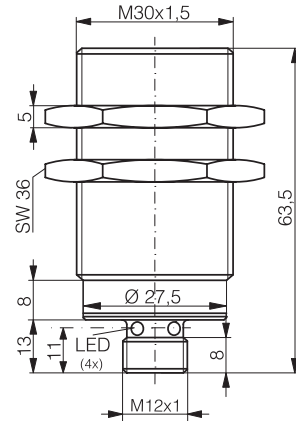

Figure 2



Cables and Accessories

Cables and accessories can be found starting on page 17-48.

